

# AM-CF25 Installation Instructions

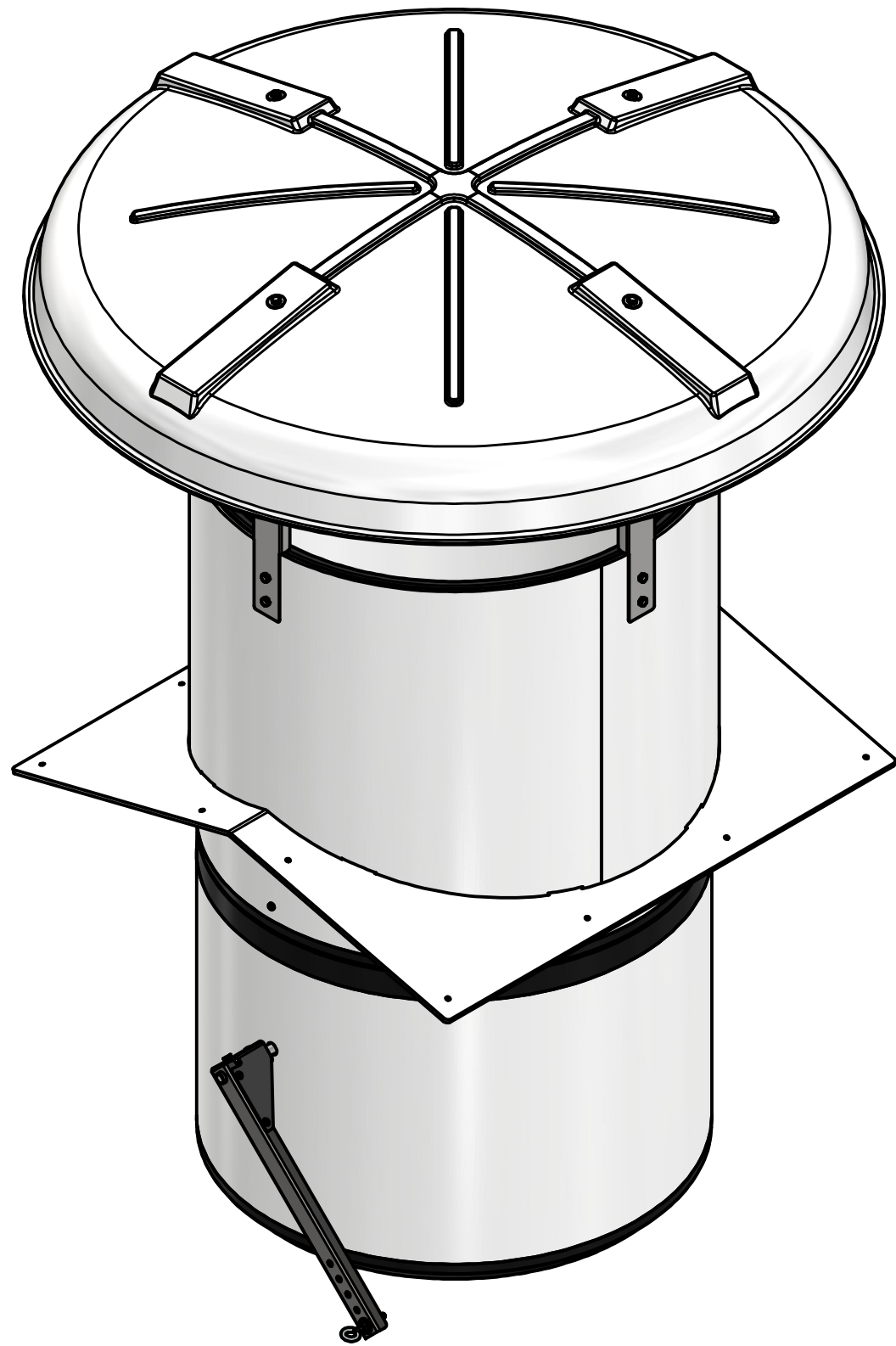

Rain Cap and brackets

AM-FLS3512

AM-CH25

AM-CDM

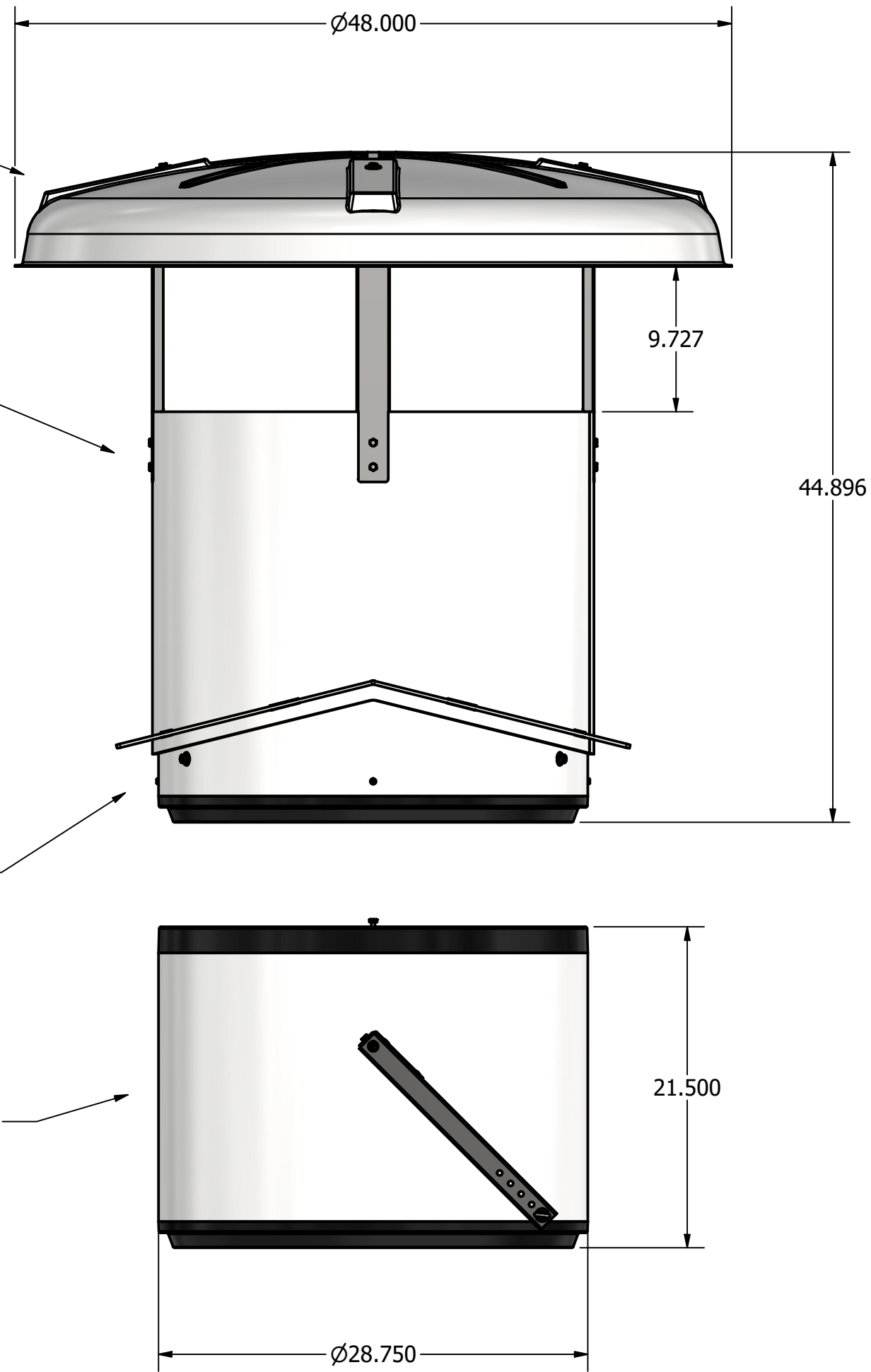

$\text{Ø}48.000$

$9.727$

$44.896$

$21.500$

$\text{Ø}28.750$

# Mounting Chimney flashing to chimney tube

**1. Slide flashing onto chimney tube until the top of the flashing is flush with the top of the chimney tube**

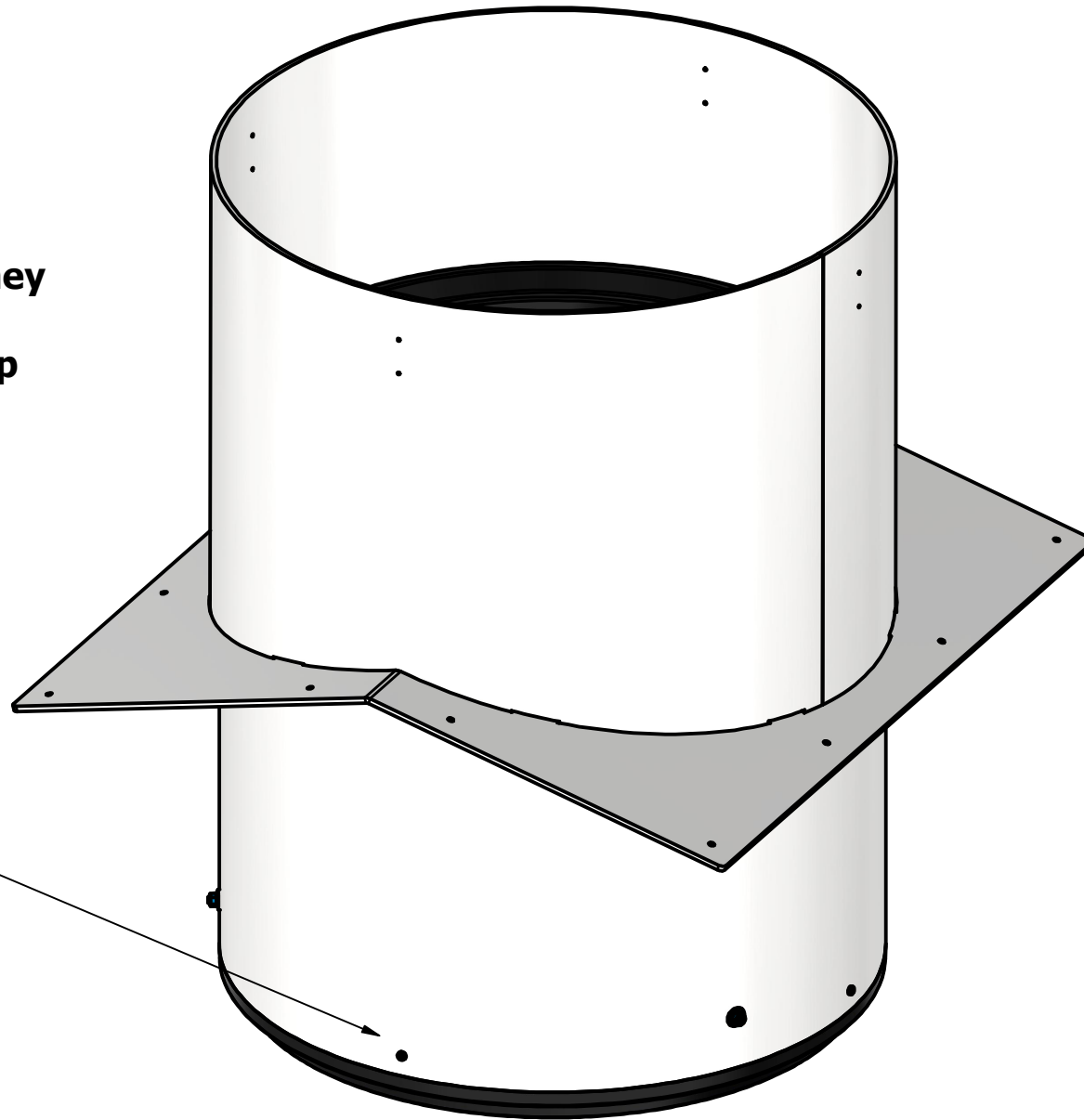

**Please note:** Removing the screws on the chimney tube will help slide flashing onto tube if the fit is too snug

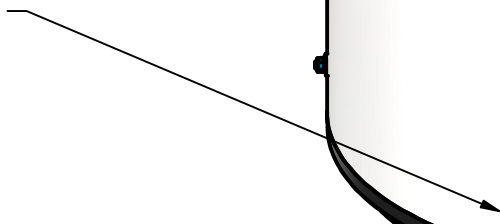

**2. Attach flashing to chimney tube using the included #10 x 1in stainless steel screws.**

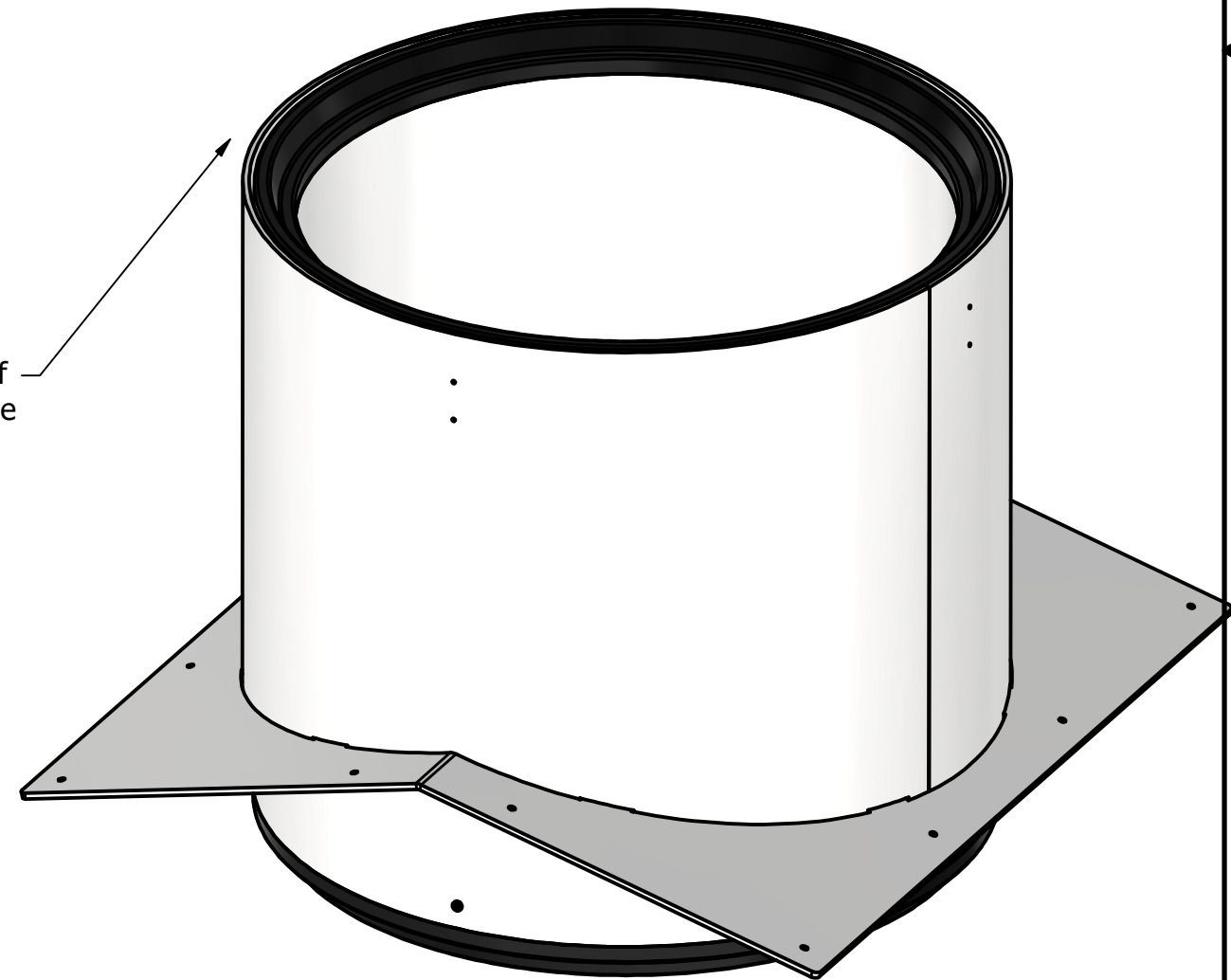

Flashing should be flush with top edge of chimney tube

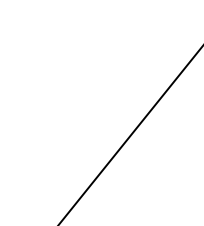

Please note: placing screws approx 2 1/4in from top of flashing will provide most secure fit, as this ensures that the screw grabs some of the top foam ring on the chimney tube

4

3

2

1

4

3

2

1

B

B

A

A

# Mounting Winch arm to AM-CDM module

1. Attach winch arm to damper rod using included 1 1/2x20 Hex bolt and nylon lock nut,

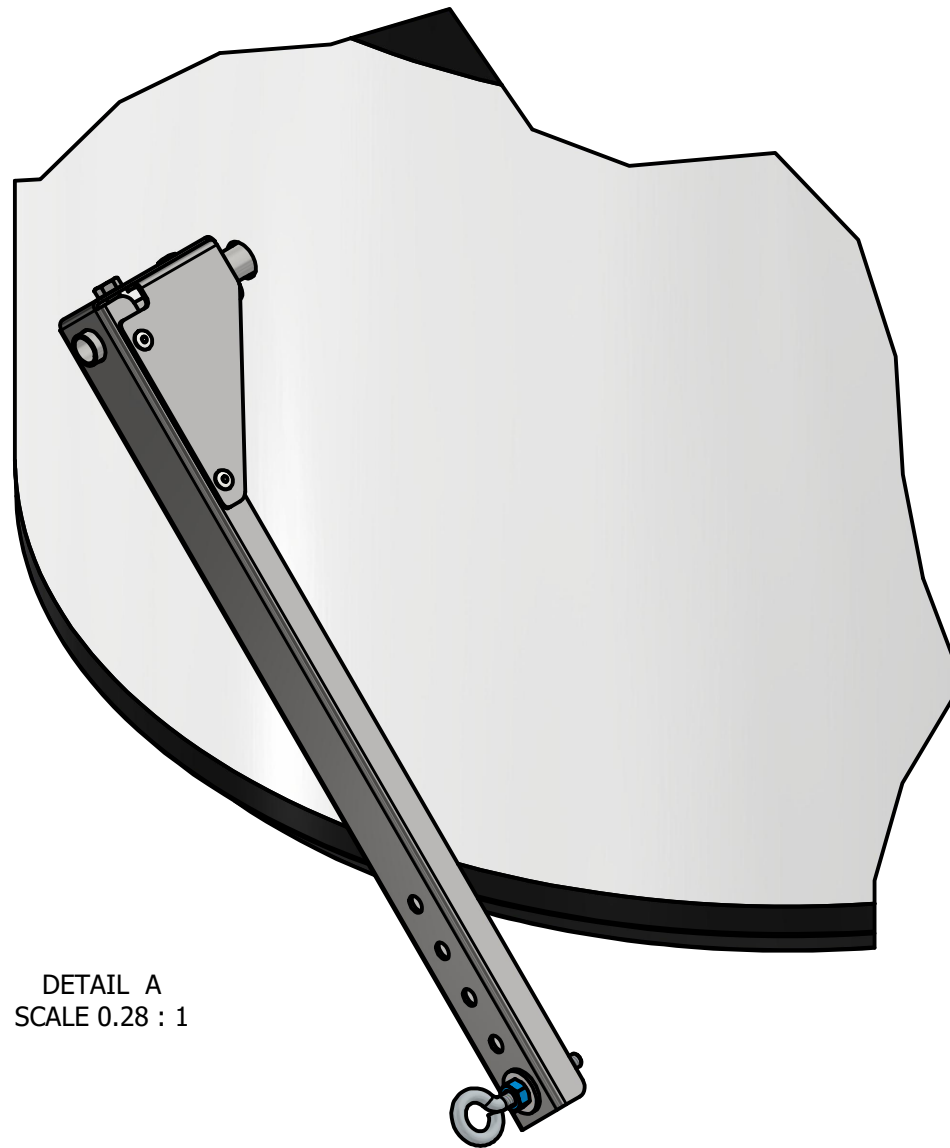

DETAIL A  
SCALE 0.28 : 1

2. Attach eye bolt to your preferred height using the included eye bolt and nuts

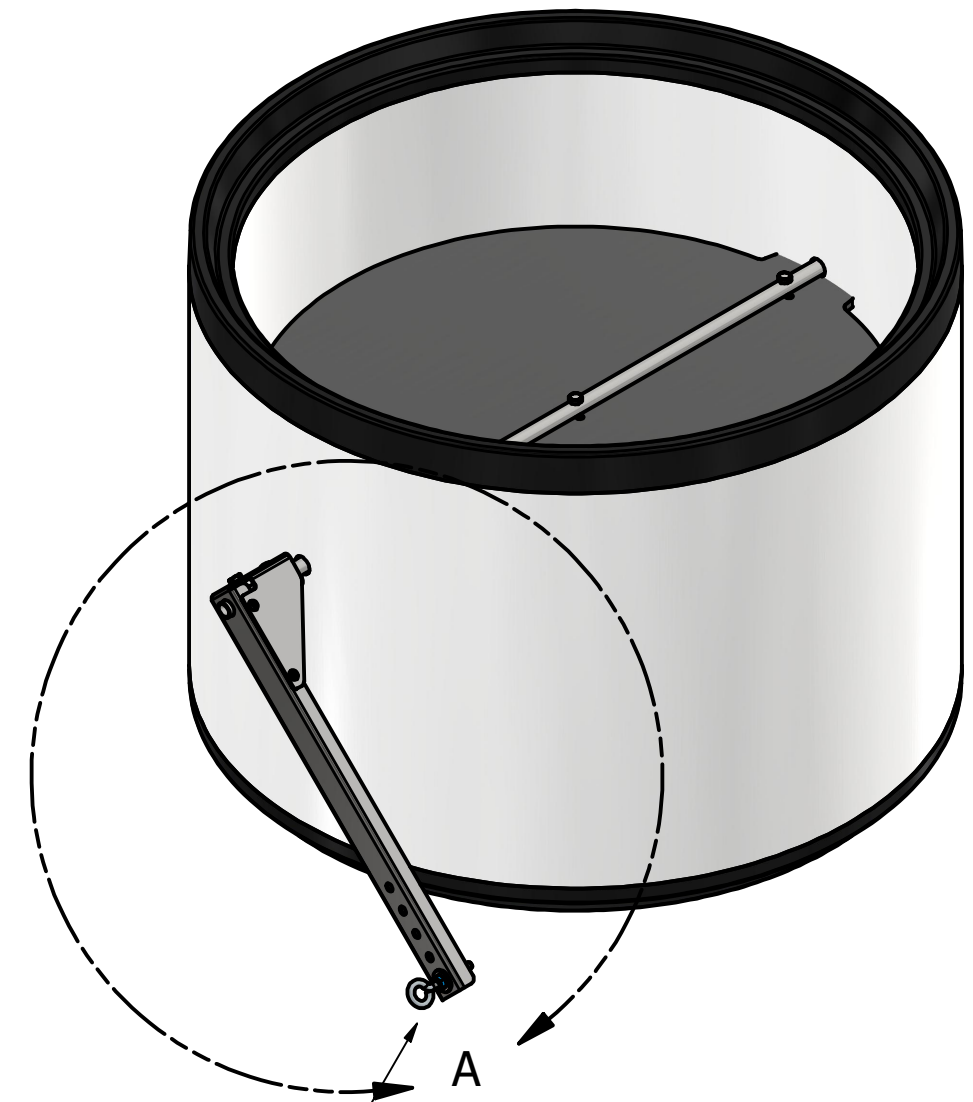

# Mounting Rain cap

## 1. Mount rain cap brackets at 90 degree intervals on chimney flashing

- Using 1/4in drill bit, drill through chimney flashing and chimney tube.
- fasten stainless steel brackets using included 2.5x1/4in bolts with washers and nylon lock nut on opposite side

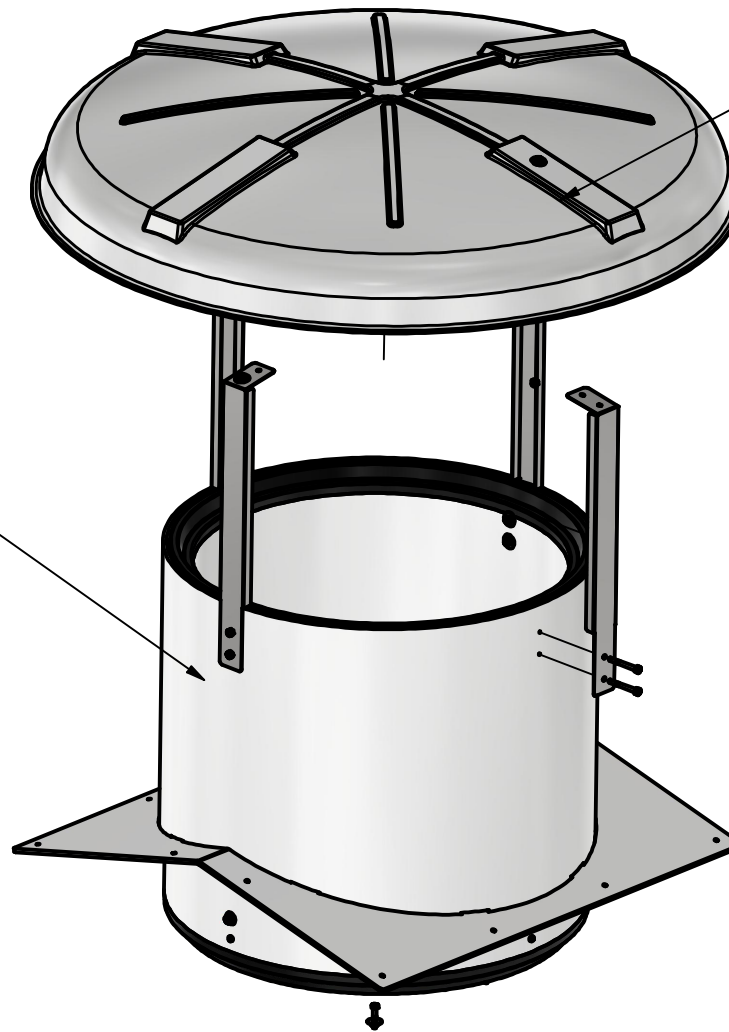

## 2. Mounting the rain cap to the mounting brackets.

- Using 1/4in drill bit, drill through rain cap
- fasten stainless steel brackets using included .75x1/4in bolts with and nylon lock nut on opposite side

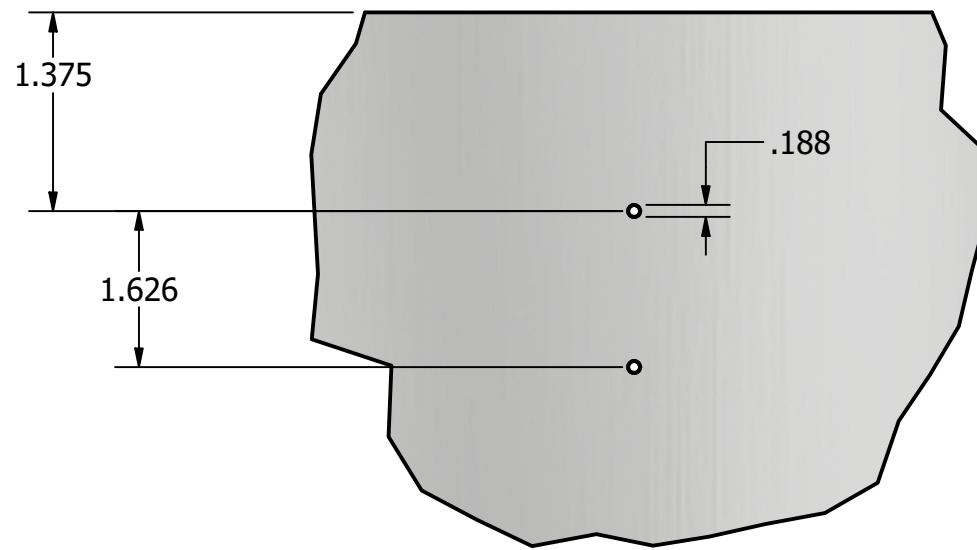
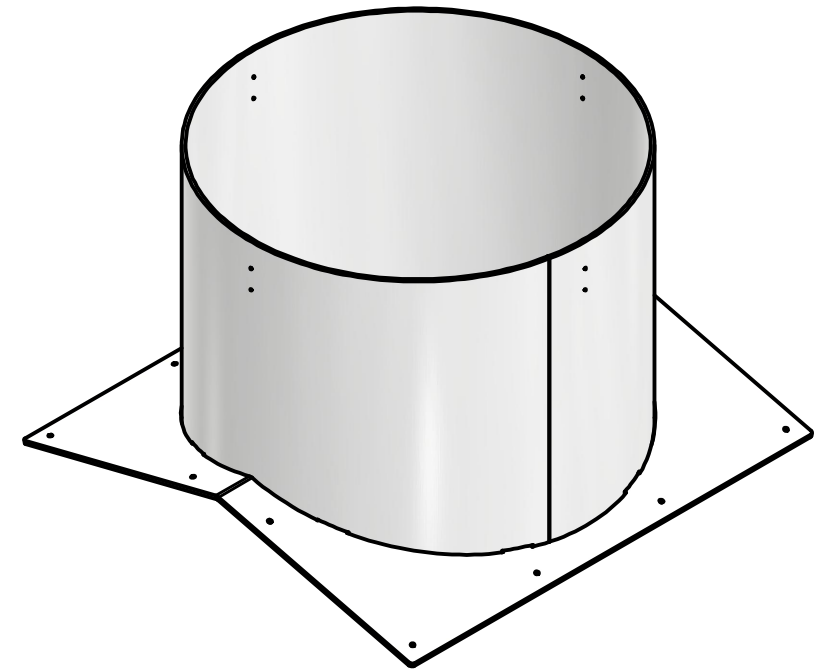

DETAIL B  
SCALE 0.5 : 1

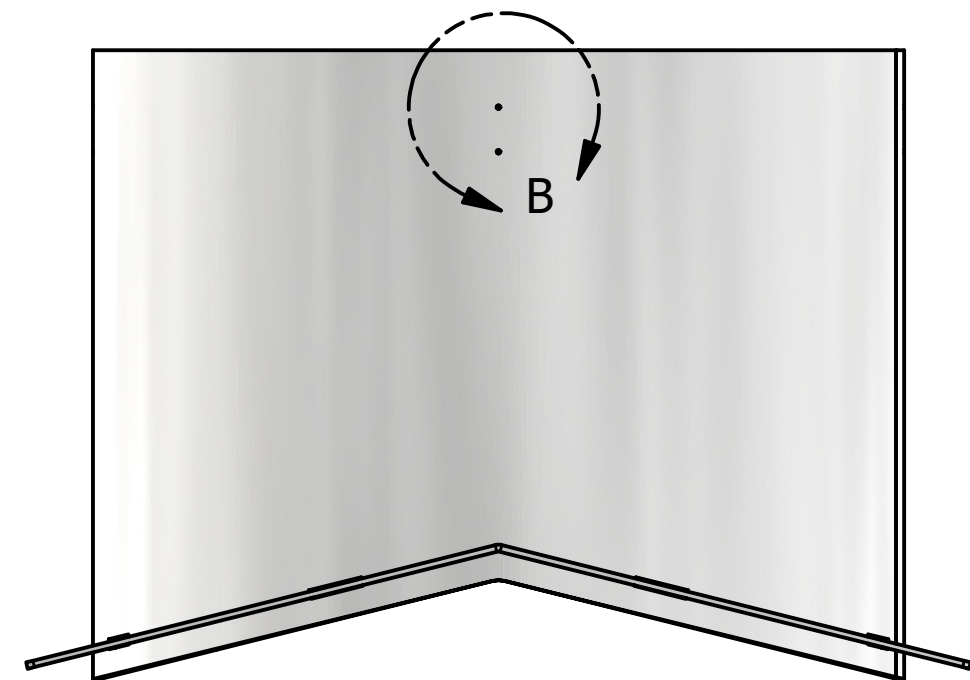

# Bird Mesh Installation

1. Use included zipties to form joint

2. Use included #10x1in Screws and plain 1in washers to fasten mesh to chimney flashing

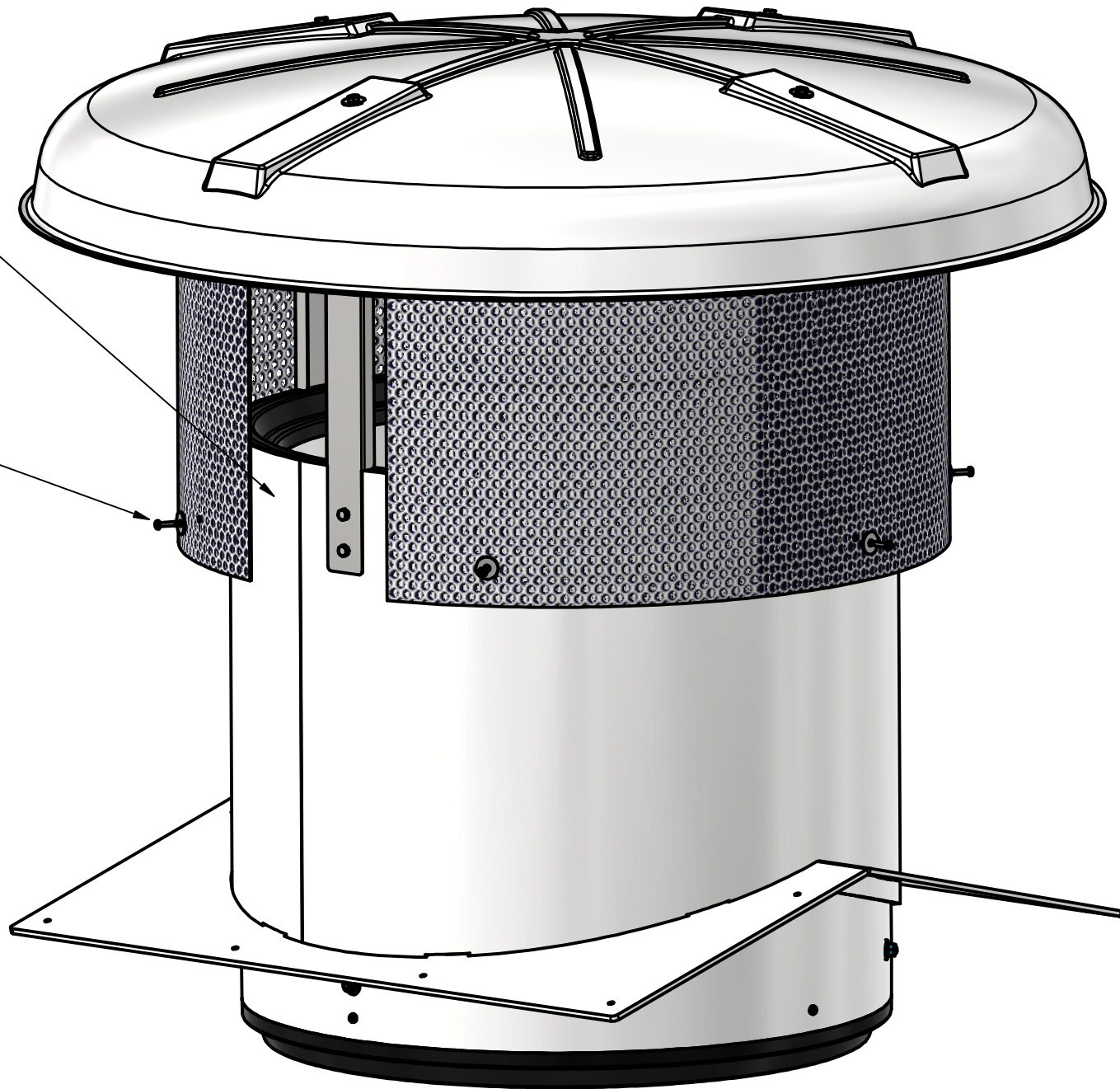

# Motor arm installation

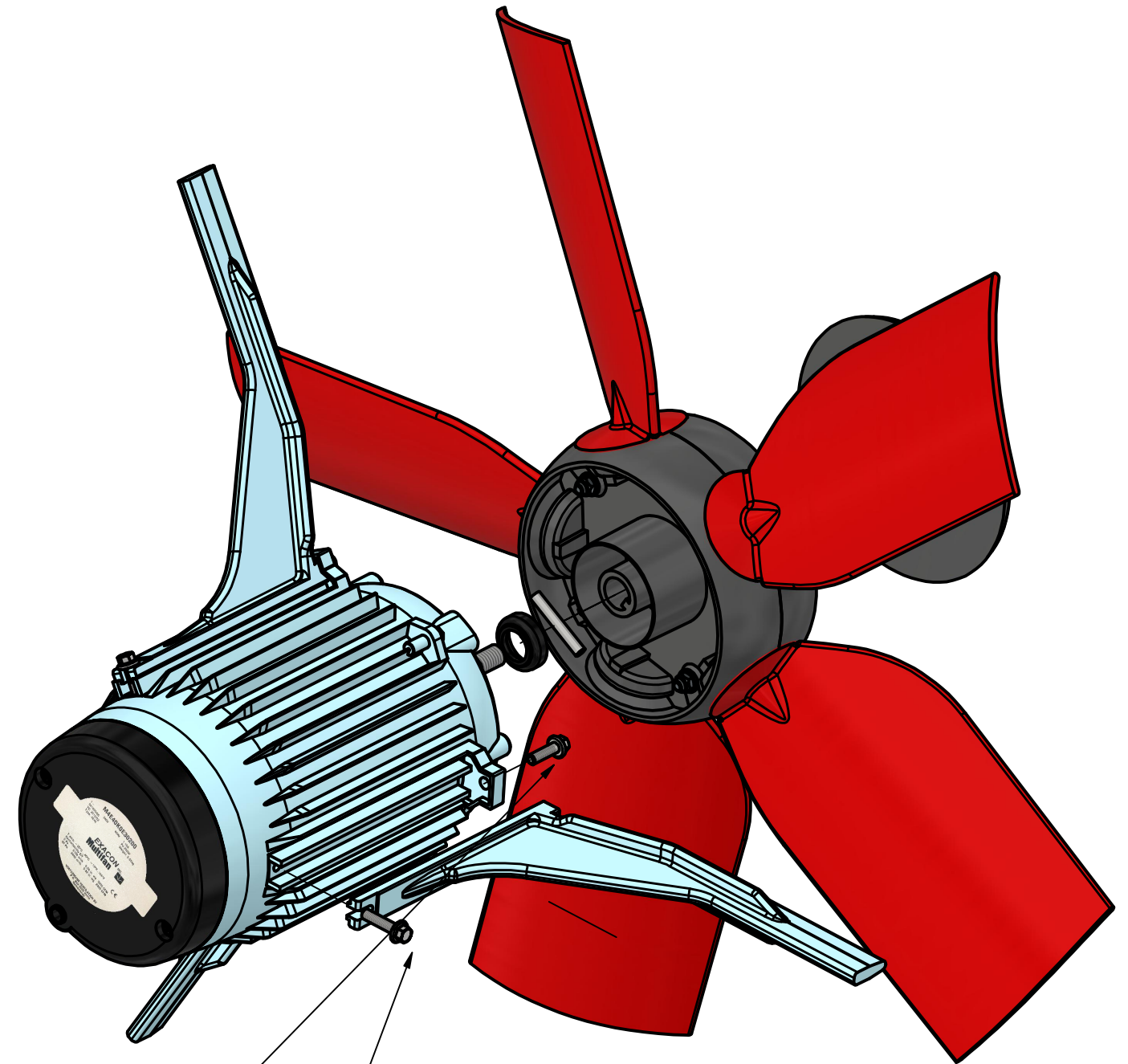

1. Remove 10mm bolt from motor arm, and insert it into top arm mounting position and tighten it to attach arm to motor

2. Finish attaching arm by tighten 10mm bolt that is attached to the motor, ensure that the bolt is correctly positioned inside the correct slot on the arm please take note to not strip and over tighten this bolt

# Blade Installation

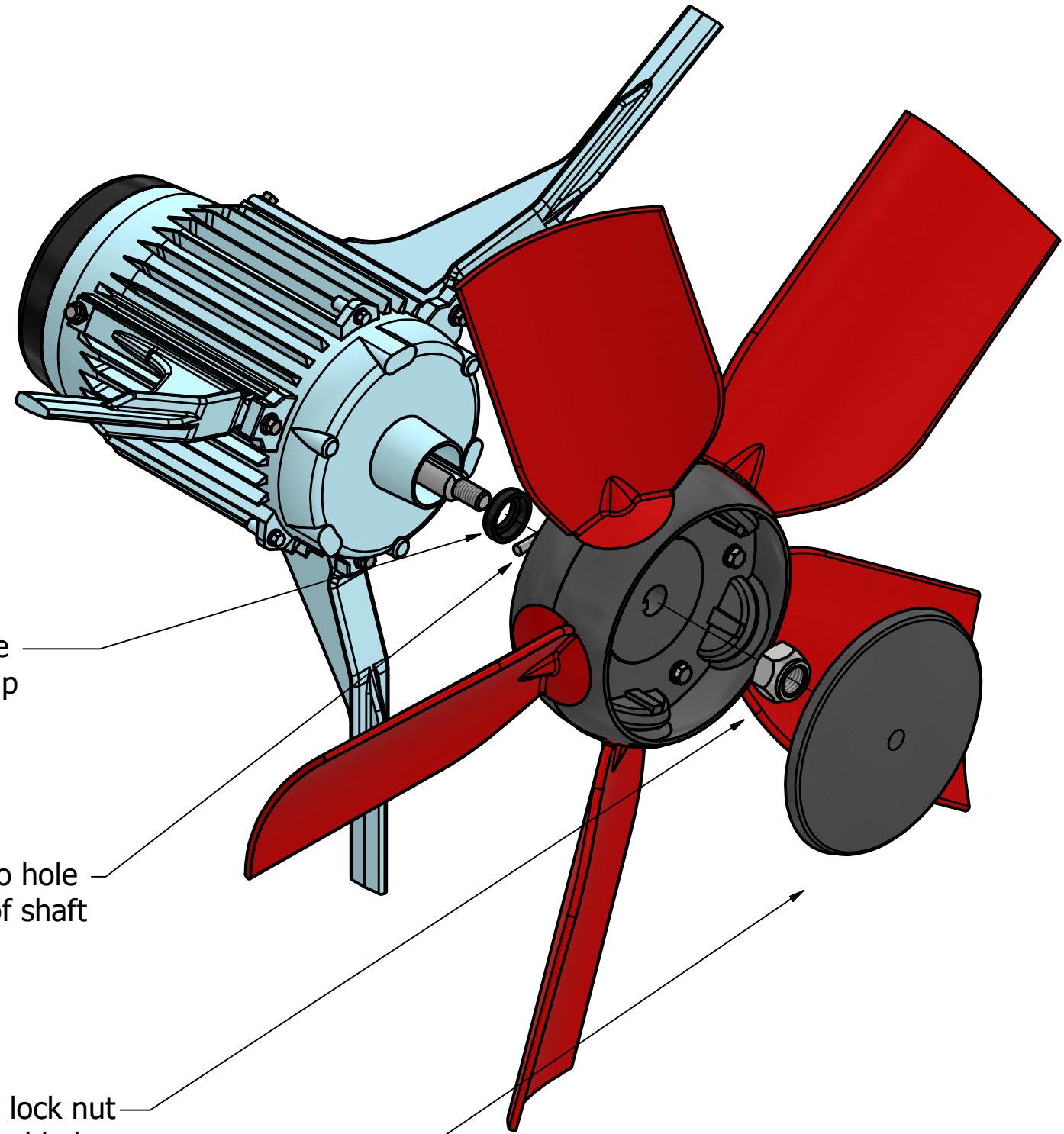

1. Install plastic spacer on motor shaft, making sure for the orientation to be correct, with cup facing up

2. Install stainless steel 1/4in pin, using a hammer, tap pin into hole on motor shaft, until it is even on both sides of shaft

3. Slide Blade onto shaft and use provided 19mm lock nut and washer to fasten blade, make sure to tighten appropriately

4. Install dust cap by snapping it into top of blade hub

**Note:** Plastic spacer, stainless steel pin and 19mm lock nut can be found in motor hardware kits

# Motor Installation

Mounting the motor into the chimney tube. Slide motor and blade into the plastic motor mounts inside the tube, and fasten using provided fasteners

1/4x20 Stainless steel lock nut

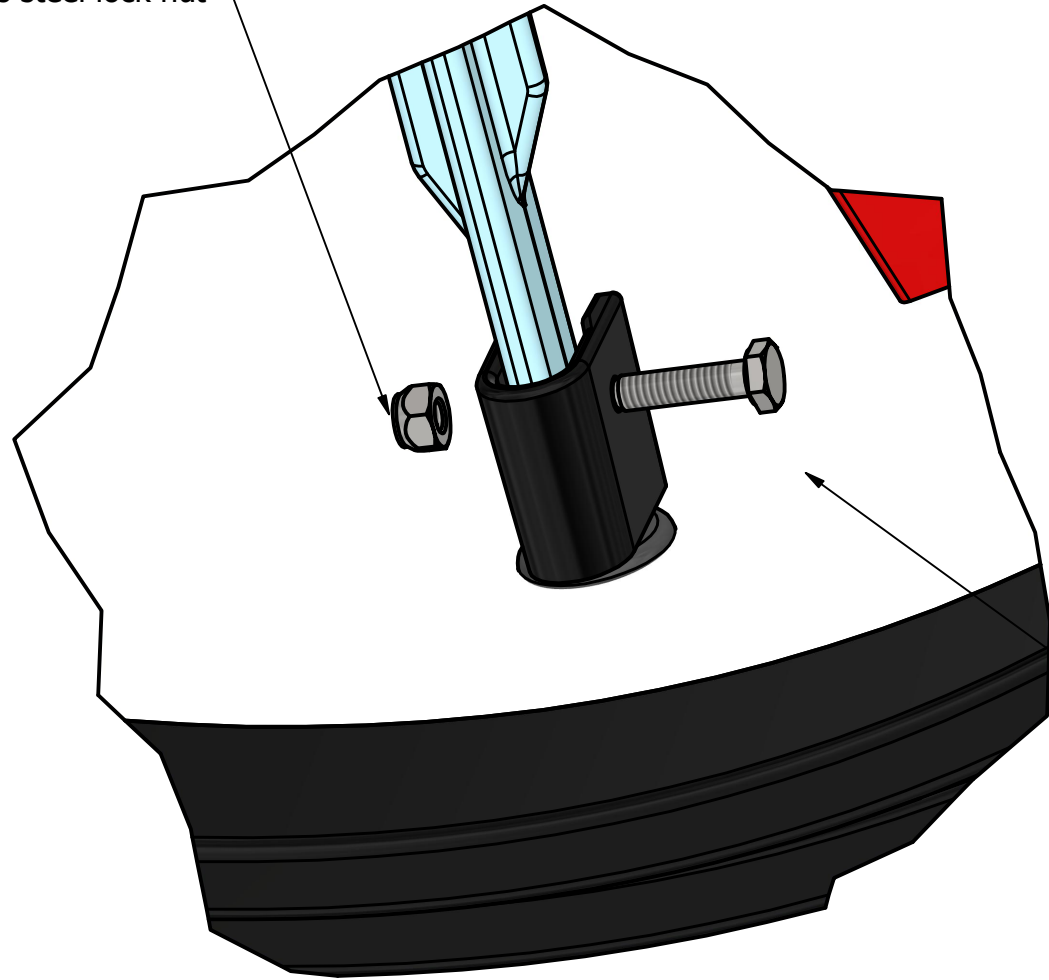

1/4x20x1 Stainless steel hex bolt

DETAIL C  
SCALE .75

